



# INSPECT FIRST. SPEND SMART.

AQUATIC INFRASTRUCTURE ADVISORY

Independent guidance.  
Stronger infrastructure.  
Better long-term outcomes.



GRAD provides commercial and residential pool infrastructure advisory, inspections, renovation planning, design support, and permitting assistance throughout **Northern Virginia, Maryland, and the DC Metro region.**



## THE CHALLENGE

Pool infrastructure decisions often involve balancing operational needs, budgets, aging systems, and long-term planning priorities. Without clear technical guidance and documented observations, it can be difficult to confidently prioritize repairs, renovations, and future investments.

Our goal is simple: help you make informed decisions that protect your investment, improve performance, and plan for the future.



## THE GRAD APPROACH

**Inspection-based. Data-informed. Solutions-focused.**  
GRAD helps clients evaluate conditions, identify priorities, and make informed infrastructure decisions that support long-term performance, efficiency, and value.



Inspect



Evaluate



Plan



Optimize



Protect

## CORE SERVICES

### COMMERCIAL SERVICES

- Aquatic Infrastructure Reviews
- Pool Renovation Planning
- Capital Planning Support
- Water Efficiency & Leak Consultation
- Technical Project Guidance

### RESIDENTIAL SERVICES

- Pool & Patio Design
- Permit Assistance
- Renovation Planning
- Construction Consulting
- Builder Collaboration

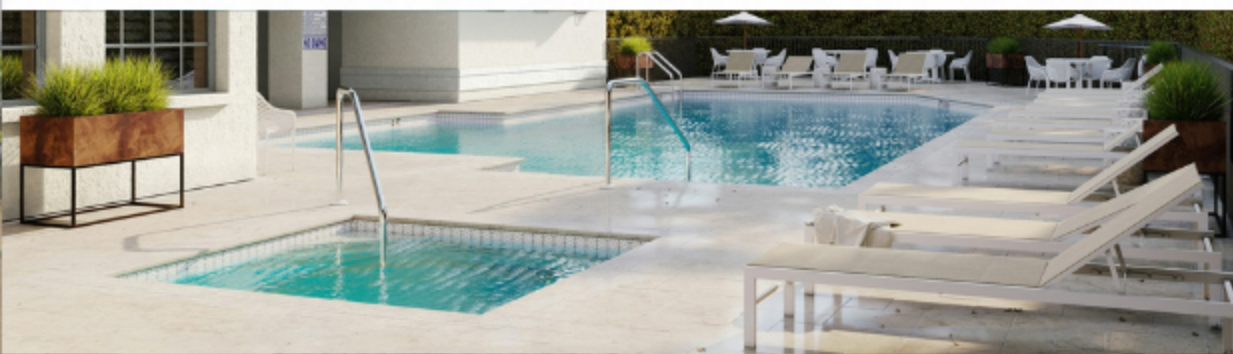

## WHY GRAD



20+ years of commercial pool industry experience



PHTA member & standards committee contributor



Certified Expert Pool Builder & Design Professional



Independent, inspection-first approach



Focused on long-term infrastructure performance and value



## SCHEDULE A SITE CONSULTATION

GRAD works with property managers, HOAs, builders, and homeowners seeking practical, long-term aquatic infrastructure guidance.



571.237.4447



contact@gradpoolandpatio.com



www.gradpoolandpatio.com



SCAN TO CONNECT



KNOWLEDGE. EXPERIENCE. INFRASTRUCTURE.